

KSQ 7453 RFID Mifare Cam Lock Overview

Model: KSQ-SHIELD 7453

Installation: Suits Metal and Timber doors requires 19mm hole or existing 19mm double 'D' hole

Description:

RFID cam lock for operation using any 13.56MHz 1K Classic Mifare RFID card, Fob or Wristband.

It has a 19mm double 'D' cylinder that comes in two lengths to suit metal or timber doors. Retrofits existing key operated 19mm cam locks in minutes. Features secure external battery access for a single CR2450 lithium battery (not included) USB-Type C emergency power port, Public or Private modes and a blinking LED indicator when locker is in use. Low battery indicator, 40mm straight cam, spur washer for timber doors, cam nut, hex nut, robust all alloy construction.



Cards/Fobs Management Programming Card (Max 3) **Master** Override Card (Max 2) **User** Card (Max 2)

Powering up the Lock: Both the black and white locks in 20mm and 30mm cylinder lengths are supplied ex-factory default in Private User mode. (Assigned locker users)

Setting up Lock

1. To setup Lock operation a single CR2450 Lithium battery is required.
2. On the lower right hand side of the silver metal lock body there is a small brass retainer pin. Using the probe provided, press the pin in, rotate the lock body slightly anti-clockwise and pull the lock body towards you to access to the battery compartment. The battery clip is spring loaded and will pop out, take care not to misplace it during battery installation.
3. Insert a CR2450 lithium battery into the battery clip so that the knurled side of the battery (negative) is facing to the top of the battery clip when inserted. The clip has a flat section at the top that must face towards the back of the lock.
4. When battery clip is installed, you may need to use the probe to push it further into the lock so the front lock body can be pushed back into position. Rotate the lock body clockwise until it engages with the retainer pin and properly secured.

Introduction

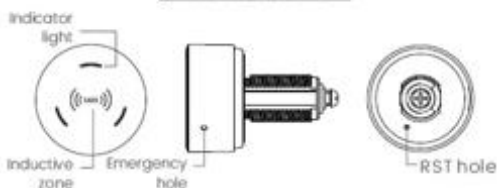

Fixing hole size&installation

> Fixing hole unit:mm

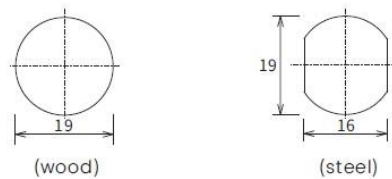

Install/replace battery

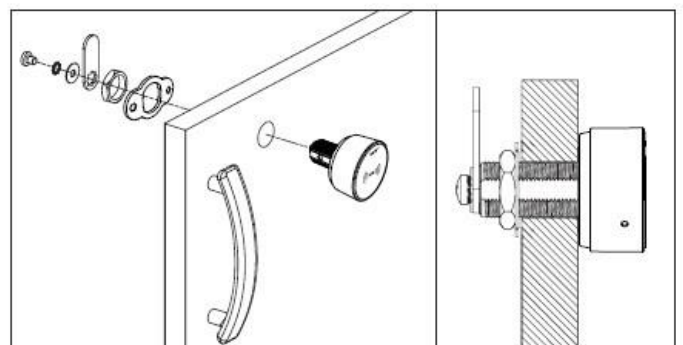
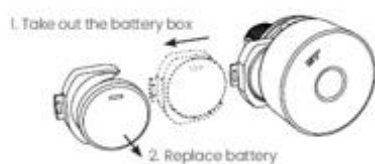
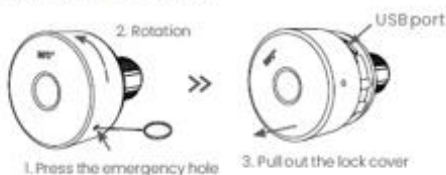

(wood)

Programming RFID Devices (Private User)

1. **To enrol the Management Card** or Fob (maximum 3)
Present a Mifare RFID Card or Fob to the lock face. The **first** RFID device presented to the lock becomes the **Management** Fob / Card. The Management fob / card can add or delete other Cards or Fobs as well as lock and unlock the lock. **A max of 3 Management Fobs / cards** can be enrolled per lock.
2. To enrol additional Management Fobs, simply present the first enrolled Management Fob to the lock twice until green lights start flashing – then present a new blank fob to the lock to enrol as the next management card. Repeat this step if you wish to enrol a 3rd Management Fob.
3. **To set the Master Override** Card or Fob (maximum 2)
Present one of the **Management** Card or Fob to the face of the lock **4 times**.
(Note lock will emit a melody of beeps when the Management card is presented the first time then green lights will flash and lock will then give 1 beep each time management card.fob is presented).
4. Now Present the **Master** Override Card or Fob.
A **max of 2 Master** Override Cards/Fobs can be enrolled per lock by presenting one after the other whilst the LED is flashing.
5. **To set the User Card** or Fob
Present one of the **Management** Card or Fob to the face of the lock **3 times**
(Note lock will emit a melody of beeps when the Management card is presented the first time then green lights will flash and lock will then give 1 beep each time management card.fob is presented).
6. Now Present the **User** Card or Fob to the reader face
A **max of 2 Users** cards can be enrolled per lock presenting one after the other whilst the LED is flashing.
7. The lock is now set with **Management**, **Master Override**, and individual **User Card** to operate in Private mode for assigned locker users.
8. Note: When lock is In Private User mode the RFID card or fob is only needed for unlocking.
To lock the lock the User simply rotates the lock body until the locking pin engages

Setting the KSQ 7453 RFID Cam Lock for Public Share Mode

1. Follow the Setting Up Lock instructions for opening front casing to access battery compartment.
Have the supplied probe and a CR2450 battery on hand.
2. Insert CR2450 battery into the black battery clip with the knurled negative (-) side facing up and partially insert the battery clip halfway into the lock. **Do not push battery completely in.**
3. Insert the Probe into the small RST hole on the back of the lock and keep it held down as you insert the battery clip. Keeping the probe held in you will hear an initial two short beeps indicating the lock has power, keep holding the probe down until you hear 3 loud beeps indicating the mode has been successfully changed from Private to Public mode and then remove the probe.
4. Push the lock body closed and rotate it clockwise until the retainer clip engages and locks the casing in place. If retainer pin does not engage you may need to use the probe to push the battery clip down further and then engage the pin.

Programming the KSQ 7452 RFID cam lock for operation in Public Mode

1. In Public mode only the **Management** cards (Max 3) can lock or unlock the lock. Master and Individual User cards cannot be set.
2. After the **Management** card has been set, any Mifare 13.56MHz 1K RFID card, fob, or wristband will operate the lock for share locker Users.
3. To lock the lock in Public mode, present the card or fob to the reader inductive zone when lock body is in open or unlocked position. In unlocked position a green LED will confirm User card has been registered, turn knob to lock. In locked position present User RFID device to lock, confirmed by a green LED
4. In Public mode the Green LED will flash every 4-seconds to indicate the locker has been occupied by another User.

Deleting All Cards

Special Note – This function will delete memory of all **Management Cards** / **Master Cards** and **User Cards** and lock will be reset back to factory settings. Management Cards/ Master Cards and user Cards will need to be re-enrolled again.

Option 1. Present the **Management card** to the Card **six (6) times** confirmed by 2 beeps that lock has been reset to factory settings

Option 2. Open Locker with Master or Management Fob/Card
Turn lock back into the locked position **but do not close the door**
Insert the probe into the RESET hole located on the back of the lock - hold down until confirmed by 2 beeps that lock has been reset to factory settings
(Please Note if lock is still in the open status it will prevent the probe fitting inside the reset hole.)

Notes:

- a. **Management** card must be set before any other cards can be set
- b. If **Management** card unlocks in Public mode, temporary user card is deleted
- c. Temporary user cards are one-time use only
- e. Three beeps indicate an invalid card
- f. Continuous beeping indicates battery is low and requires changing as lock may not operate with flat battery.
- g. When battery is flat and locker door is locked, remove battery as per above instruction. If replacement battery is not on hand, connect and emergency power bank (sold separately) into the Emergency power USB port.